

高雄市第88期市地重劃區重劃前地價圖

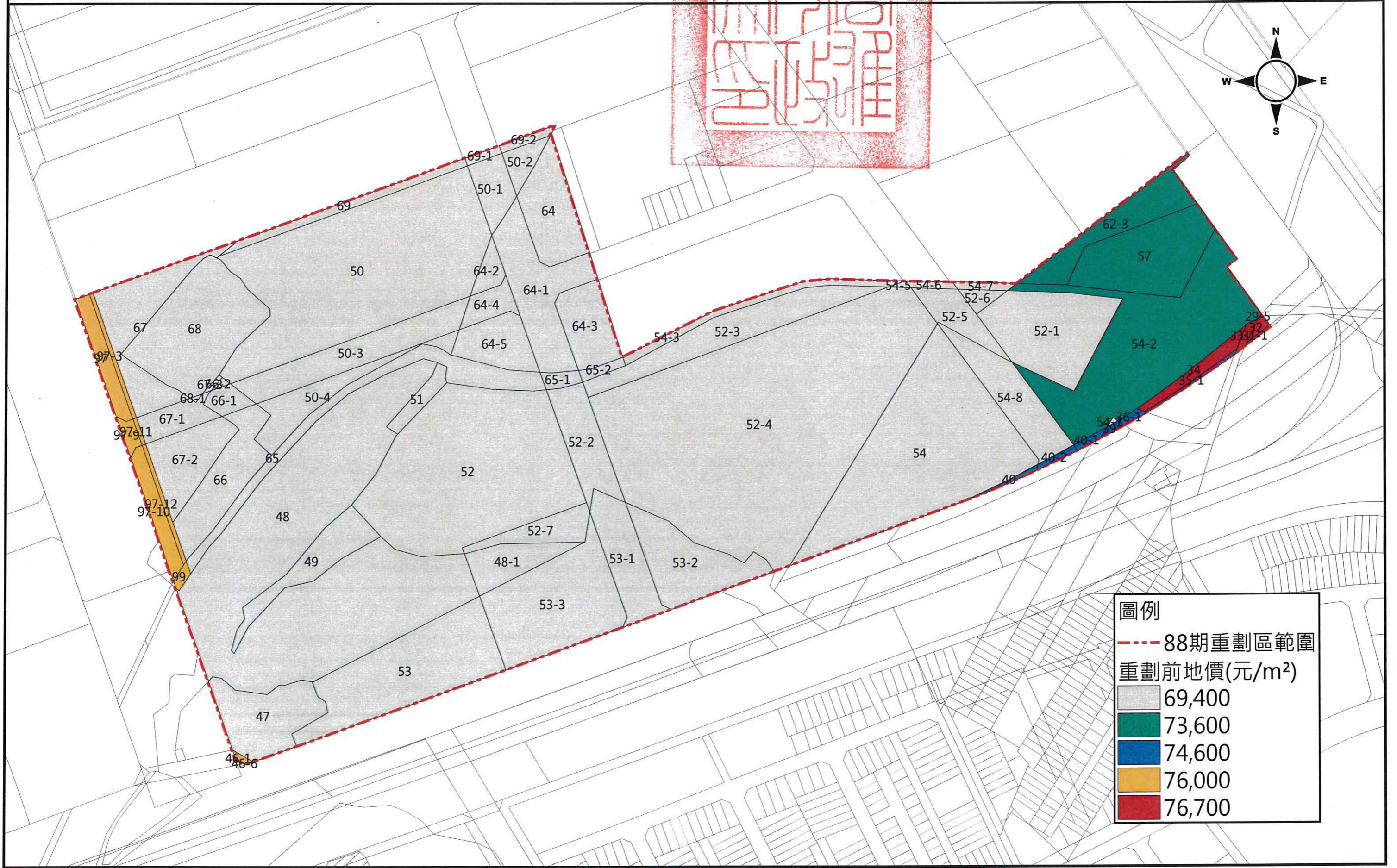

圖例	
	88期重劃區範圍
重劃前地價(元/m ²)	
	69,400
	73,600
	74,600
	76,000
	76,700

高雄市第88期市地重劃區重劃後地價圖

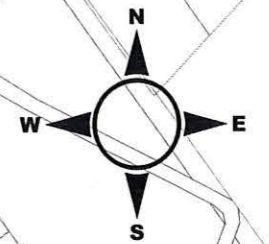
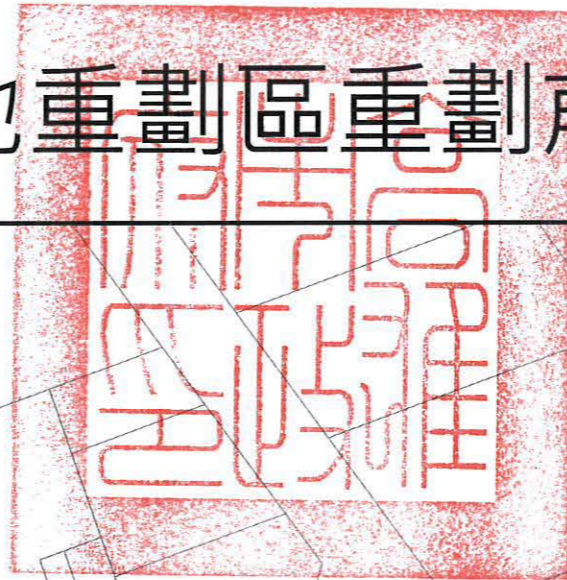
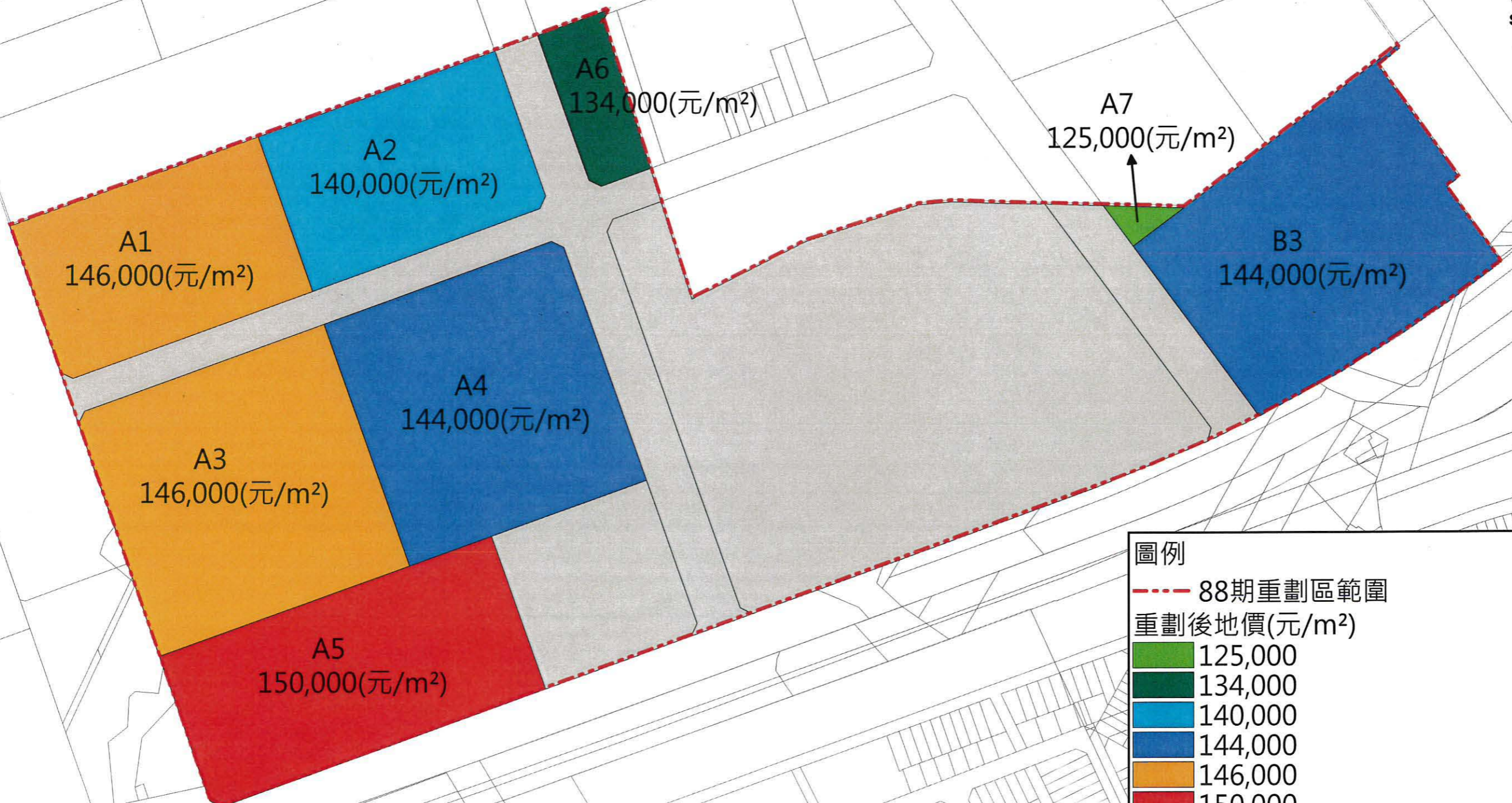
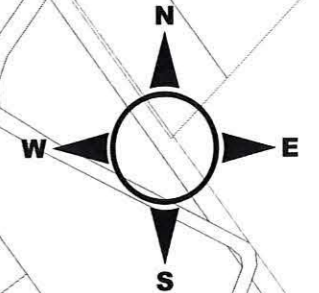
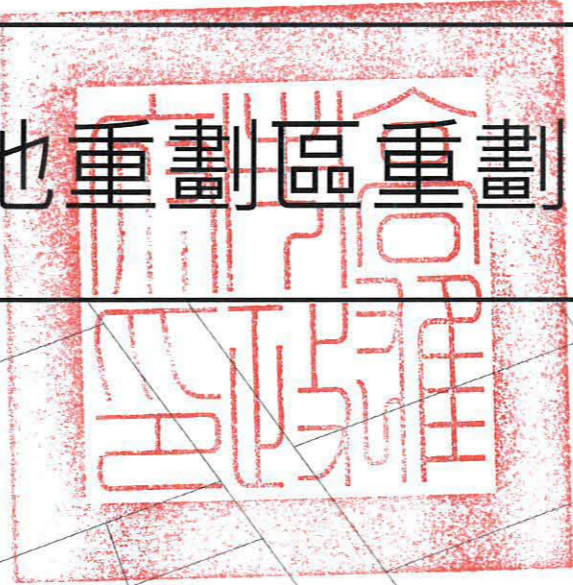

圖例	
--- 88期重劃區範圍	
重劃後地價(元/m ²)	
■ 125,000	
■ 134,000	
■ 140,000	
■ 144,000	
■ 146,000	
■ 150,000	
■ 90,000(公園、廣場停車場、道路)	